

OUR VISION

All children with special needs will have every opportunity to pursue his or her goals, realize his dreams and reach his full potential. Every parent or caregiver of those children will be provided with information, resources and encouragement in order to best support his or her child.

OUR MISSION

To provide traditional and innovative therapies and recreational opportunities for children with special needs in an environment that is family-friendly, to include resources and education for the parents/caregivers.

EXPANSION PLANS:

The future plans for The Therapy Place consist of a 4,500+ square foot building addition, enhanced inclusive playground, parking and grounds improvements.

The additional building space will allow for the following improvements to facilities:

- more suitable space for the Bridges preschool
- a large kitchen for therapy and preschool use
- a second large gym area and additional therapy rooms
- a large, multi-purpose room for family & recreational events, community activities and preschool presentations
- family restrooms located outside of the therapy vicinity
- family resource room with bookshelves and comfortable furniture
- conference room for family meetings, workshops for staff and families

THERAPISTS:

Erin Maltba, MS, OTR/L – Occupational Therapist
 Mandy Martin, MSR,OTR/L – Occupational Therapist
 Anna Mortensen, MHS, OTR/L; Occupational Therapist/TheraSuit
 Genevieve Penland, Pediatric Therapy Director/Occupational Therapist
 Danielle Fordham, DPT, Physical Therapist
 Mandi Stoner, DPT, Physical Therapist/TheraSuit
 Jackie Griffo, MSP, CCC/SLP; Speech Language Pathologist
 Ashley Reames, Speech Language Pathologist
 Katherine Smith, MA, CCC/SLP; Speech Language Pathologist

OPERATIONS STAFF:

Dawn Darby, MPA; Co-Founder and Executive Director
 Beverly Dunston, Front Desk Coordinator
 Teresa Fleming, Billing Manager
 Austine Harris, Development Director
 Joye Lee, MPH; Family Services Coordinator
 Terry Reid, Associate Director

BRIDGES STAFF:

Heather Boatwright, Bridges Aide
 Mellie Boozer, M.Ed., Bridges Co-Director
 Aaron Bruner, Bridges Aide

Mitchell Graham, Bridges Aide
 Vander James, Bridges Aide
 Liz Pierce, CCC-SLP; Speech Language Pathologist/Bridges Co-Director

Dear Friends:

I must admit I'm a little emotional when thinking back about the history of The Therapy Place. People often ask me if I ever thought it would turn out like this. While I did expect and it was our goal to fill a void in the midlands for innovative programs, I had no idea how MANY children or the even larger effect of bringing the special needs community together, families who share their most personal and vulnerable stories with us and each other.

I thank God for helping us find such talented and caring staff and for keeping the budget sound despite the many challenges along the way. I hope that you feel as proud as we are about the progress made and the impact of your involvement, be it time, dollars and/or prayers! We are so appreciative of it all!

We started with 11 children in a summer camp at Trinity Episcopal Church in 2009, moved to our current building in 2010 and started fully as a therapy and preschool center in 2011. As of the time of this letter, we have served 518 children in our facility, many of whom have been with us the entire five years!

This 2015-16 annual report commemorates our 5-year anniversary -- celebrating all of the many families who call The Therapy Place their second home and the many children we have watched achieve first milestones. We hope you enjoy learning more about the families we serve and the impact of your gifts.

Our next steps will have us adding on to our existing building and upgrading our outdoor facilities. Stay tuned for fundraising opportunities and other announcements.

Thank you and God Bless!

Dawn M. Darby

Executive Director/Co-Founder

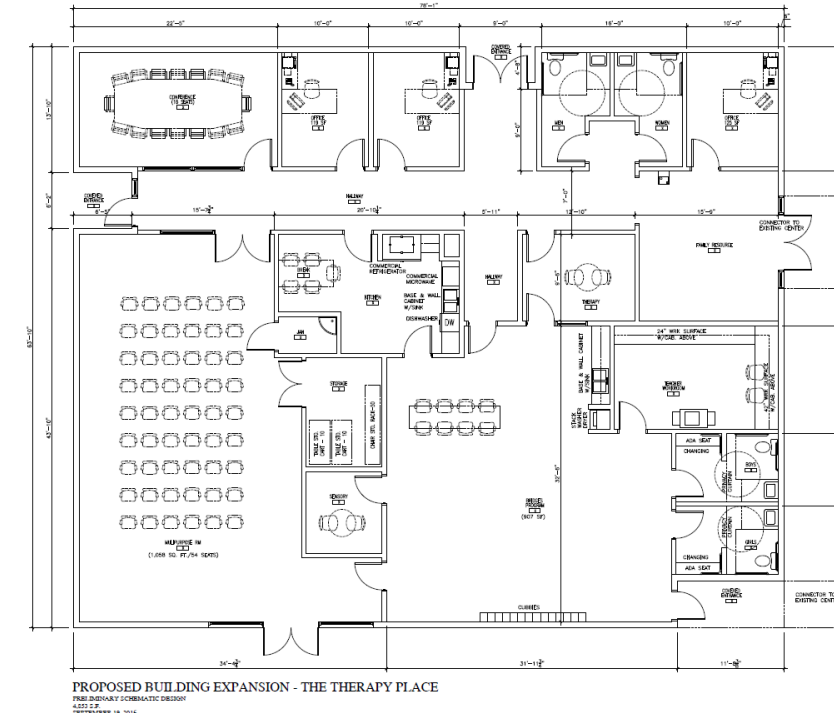
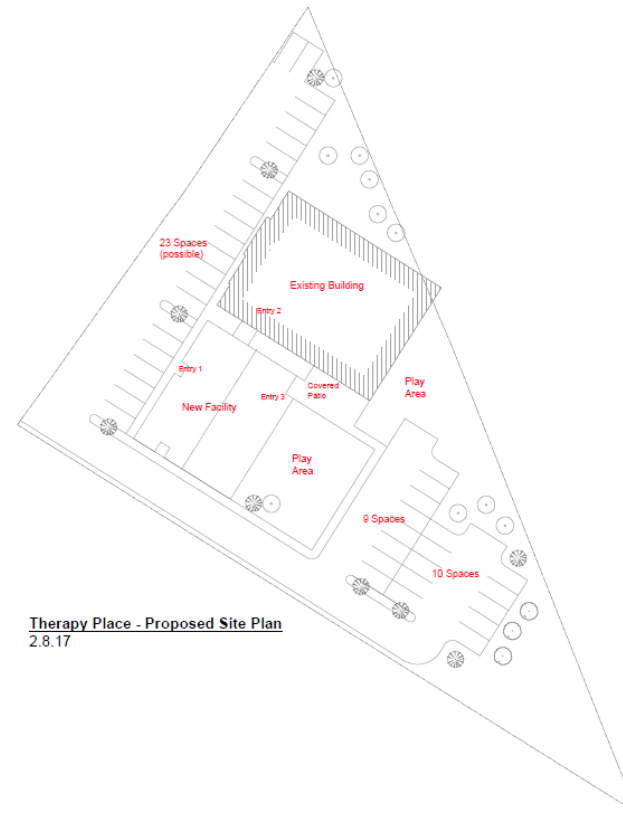

To learn more about these plans or how you can help make this plan a reality, please visit our web site or call (803)787-3033.

2016 FINANCIALS:

REVENUE: \$1,073,643

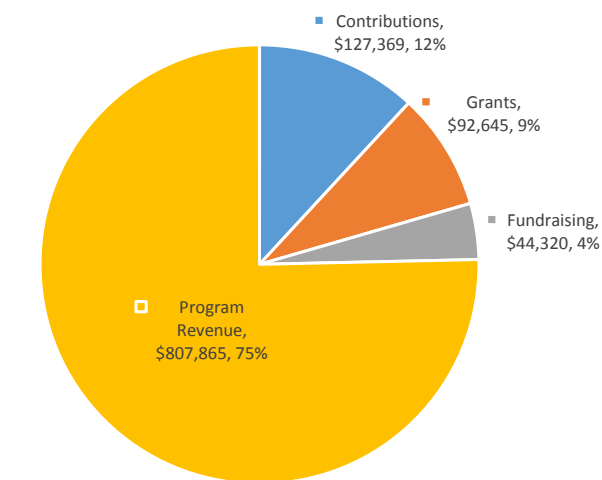

EXPENSES: \$952,499

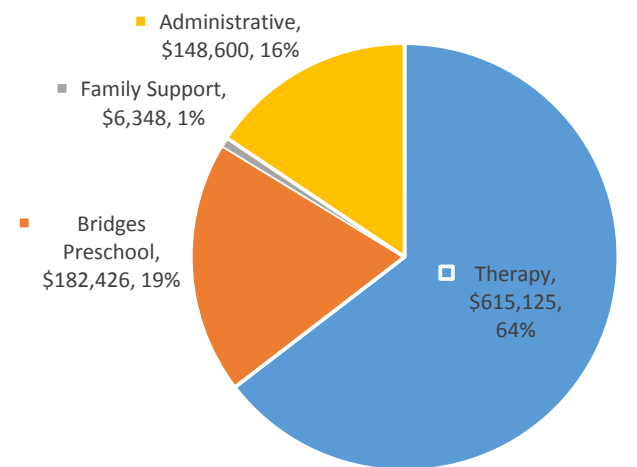

VOLUNTEERING:

Pre-therapy student volunteers and interns provided over 3,000 hours. Another 420 hours were provided through administrative, fundraising and grounds work, over \$50,000 worth of volunteer time.

WHO DID WE SERVE IN 2015-16?

We serve children ages 0-18 with the following diagnoses/challenges:

Developmental delay	Spina Bifida
Autism	Apraxia
Cerebral palsy	Spinal cord injury
Down syndrome	Albinism
Angelman syndrome	Rett Syndrome
Sanfilippo syndrome	Hearing loss
Leukemia	Costello Syndrome
Brain tumor	Torticollis
Epilepsy	Sensory Processing Disorder
Hydrocephalus	Auditory Processing Disorder
Traumatic brain injury	Chiari Malformation
Stuttering	
Behavior problems	
ADD & ADHD	
DiGeorge Syndrome	

From the following counties:

Fairfield	(1, 1%)
Kershaw	(15, 9%)
Lancaster	(1, 1%)
Lexington	(33, 19%)
Orangeburg	(5, 3%)
Richland	(119, 68%)
York	(1, 1%)

92% MEDICAID PATIENTS

64% Medicaid only
35% Commercial Insurance and Medicaid

WHAT SERVICES DID WE PROVIDE IN 2015-16?

- **8,654** total hours of therapy
 - 2,293 - **Physical** – gross motor, walking, standing, maneuvering his or her environment, riding a bike
 - 3,147 - **Occupational** – fine motor, sensory, self-help skills such as dressing, feeding
 - 3,214 - **Speech** – language, communication, chewing & swallowing, social skills
- **165** children attended regularly each week as referred by area pediatricians. Each child attends an average of 3 hours per week of therapies. Some children attend as many as 6 hours per week, while some may only attend one or two hours.
- **18** children attended the Bridges early intervention program where he or she received 30 hours per week of preschool instruction and therapies in a team approach.
- **8** Family Fun Days for an average of 15 families.

Families received support through monthly workshops and outings. Our first Healthy Me/Healthy Family conference provided 35 parents with 9 workshops while their children (32 in all) were safe with our staff being entertained with music and magic.

THANK YOU TO OUR MIRACLE MAKERS OF 2015-16:

AmerisBank	DFAHCO	Rotary Club of Spring Valley
Ms. Martha Barss	First Citizens	Sisters of Charity Foundation of SC
Belgard Hardscapes	Hoover Buildings of Lexington	SC Developmental Disabilities Council
Richard and Peggy Boatwright	Junior League of Columbia	St. Martin's-in-the-Fields Foundation
BlueCross BlueShield of SC	KW Beverage	Stier Supply Company
Cheerful Giver	Lipscomb Family Foundation	Syrian Lebanon American Society of SC
Colonial Life Challenge for Charity	Ms. Jean Moore	Trinity Episcopal Cathedral - Bazaar
David & Diana Engle	Regions Insurance	Vaughn Belting Company

AND OUR COMMUNITY PARTNERS:

BB&T Boyle Vaughan Insurance Group	Kroger
Central Carolina Community Foundation	Pediatric Mobility Innovations
Kiwanis Club of Columbia - Golden K Foundation	Riggs Partners/CreateAthon
Kohl's	Rotary Club of the Vista Night

BOARD OF DIRECTORS:

Jason Burkett, First Citizens
 Jeff Davis, President, Marketing Strategist, Palmetto Health-USC Medical Group
 Tim Kelly, Public Outreach, SC DHEC
 Mary King, Vice-President; Anchor, WIS-TV
 Caleb Riser, Attorney; Richardson Plowden & Robinson, PA

ADVISORY COUNCIL:

Kim Conant; LPN; Special Needs Care Coordinator; Palmetto Pediatrics
 Temus C. Miles, Jr., Attorney; The McKay Law Firm
 Dr. Harley Morgan, Pediatric Neurologist; University Specialty Clinics
 Dr. Carol Page, CCC-SLP, ATP; USC School of Medicine
 Langley Shealy, Communications; Sisters of Charity Foundation of SC
 Dr. Lawrence Siegel, Professor; University Specialty Clinics
 Jill Smith, LISW-CP; Jill Smith Counseling

DONATE VOLUNTEER SPONSOR

www.thetherapyplace.org

3620 Covenant Road,
Columbia, SC 29204

info@thetherapyplace.org

803-787-3033

THE THERAPY PLACE



2016 ANNUAL REPORT